

DSM Series Aluminum Alloy Dovetail Guide Linear Stages

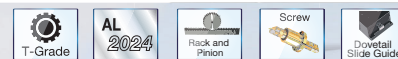

Description:

The main material of this products is black anodized aluminum alloy. Grinding lead screw drive, dovetail guide guide are equipped to guarantee strong load capacity high sensitivity, and the adjustment speed is slow. In addition, due to the small diameter of the lead screw, it is not suitable for large travel applications. The product has a scale on the side and a locking function.

Features:

- Dovetail guide, high load capacity
- Grinding lead screw, better sensitivity
- Vernier scale for easy reading
- High stability: with excellent locking function

Naming rules:

DSM 50 S-6590 E

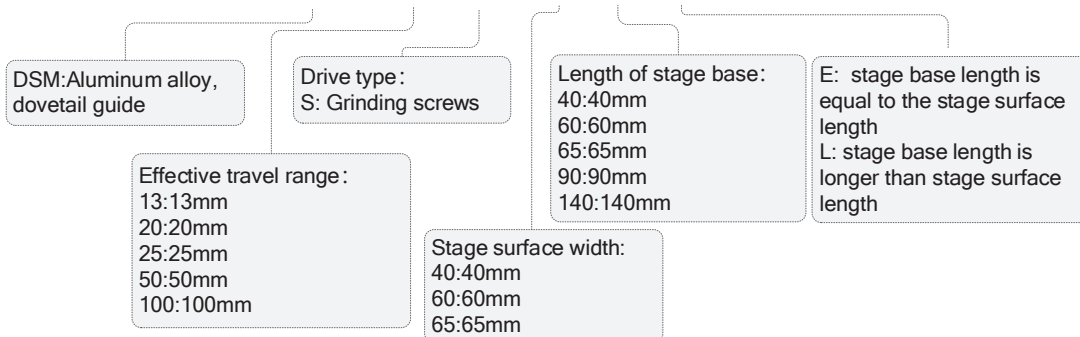

Selection chart:

Model	DSM13S-4040E	DSM20S-6060E	DSM25S-6565E	DSM50S-6590L	DSM100S-65140L
Travel range(mm)	13	20	25	50	100
Stage surface size(mm)	40×40	60×60	65×65	65×65	65×65
Main body length(mm)	40	60	65	90	140
Thickness(mm)	20				
Guide mechanism	Dovetail guide				
Drive type	Lead screw, $\phi 6 \times 0.5$		Lead screw, $\phi 6 \times 1$		Lead screw, $\phi 8 \times 1$
Drive location	center				
Main body material, surface treatment	Black anodized aluminum alloy				
Weight(Kg)	0.12	0.22	0.25	0.3	0.4
Vernier minimum read-ing(mm)	0.1				
Horizontal direction(Kg)	5	8	10	10	10
Central load capacity(Kg)	2	3.5	5	5	5

Dimensions:

DSM13S-4040E

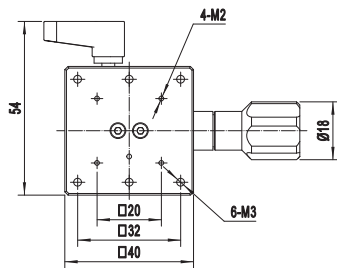
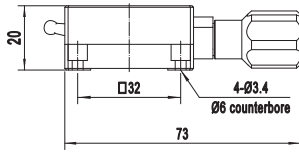
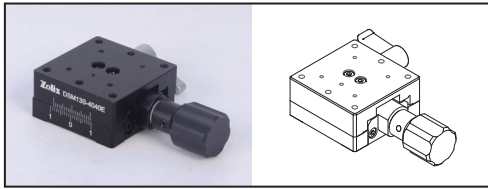

DSM20S-6060E

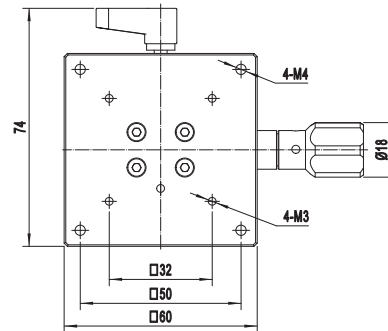
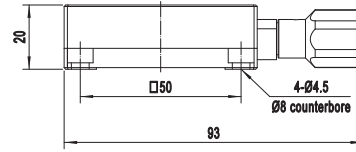
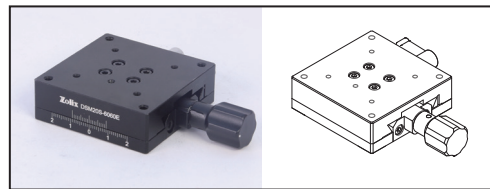

DSM25S-6565E

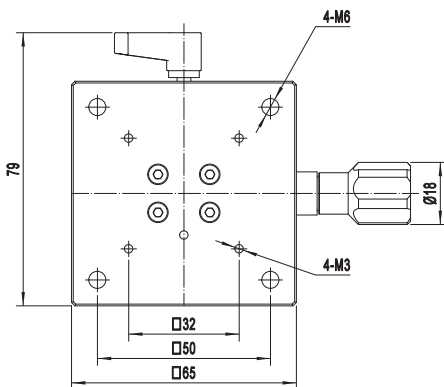
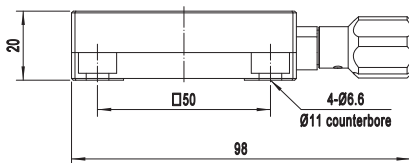
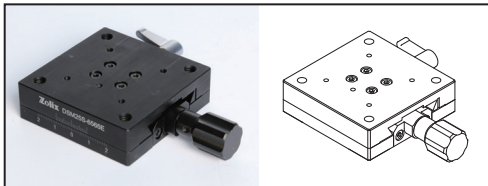

DSM50S-6590L

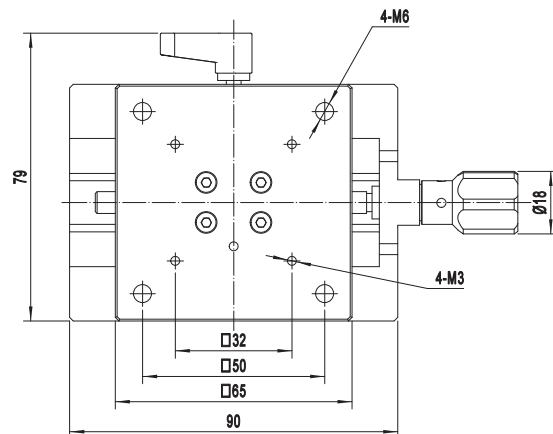
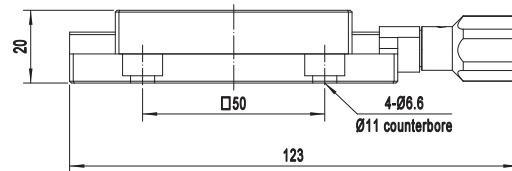
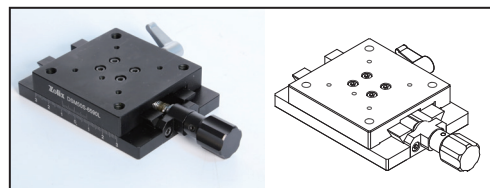

DSM100S-65140L

